



1242 RFID RLS
INSTRUCTION MANUAL

540.298.8906

For more information, tips, tricks, and videos visit us at tacticalwalls.com.



**READ ALL INSTRUCTIONS BEFORE YOU
INSTALL YOUR TACTICAL WALLS SHELF**

Our shelves have been designed to work with standard pine 16" on center 2x4 or 2x6 stud construction. Tactical Walls does **NOT** recommend installing your shelf on any other type of wall.

When attaching something to a wall, please know *exactly* what is behind the surface of the wall. If you are not comfortable with safely hanging a shelf on your wall, we recommend hiring a licensed, bonded, and insured contractor to install the shelf for you. In all things: **SAFETY FIRST!**

We highly recommend that you have a friend help you with this installation. Due to the size and moving parts of the shelf, a single person attempting to install it alone can potentially cause a dangerous situation. Two sets of hands will make this process much simpler, and more fun.

Proper tools in good working condition are a must. Please use your tools in a manner consistent with the manufacturer's intended use. Tools that should be considered for a safe installation include:

- A friend
- Safety glasses
- Stud finder
- Tape measure
- Pencil
- Level
- Drill & Drill Bits
- Electric screw driver

Failure to follow these instructions could result in INJURY or even DEATH!

WAIT TO PLACE THE BATTERIES IN THE RFID LOCKS UNTIL STEP 7 OF THESE INSTRUCTIONS.
NEVER CLOSE YOUR RFID UNIT WITHOUT A WORKING BATTERY IN THE LOCK. NOT EVER.

LET'S GET STARTED!

Step 1.

Get your tools together to complete your installation, including a friend. Remove the foam insert from inside of your shelf until later instruction.

Step 2.

Confirm that the wall has adequate support by finding the studs with a stud finder. See Figure 1. Note: This shelf is designed to work with 16" on center framing. Your wall spacing may vary.

Mark your stud locations and transfer those measurements onto your shelf. Drill three pairs of pilot holes – 2 holes per stud in a vertical line at least 2" apart, with 16" between each pair – through the back of the shelf within the marked stud locations. See Figure 2. We recommend using a 1/8" drill bit for the pilot holes. If the holes are too big, the screws will pull right through the back of the shelf. Please use the proper drill bit.

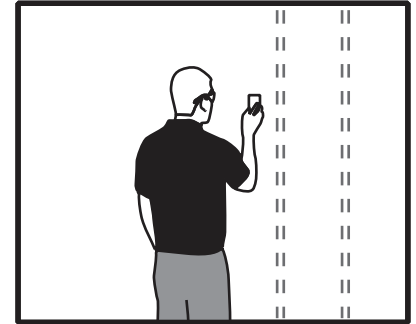

Figure 1

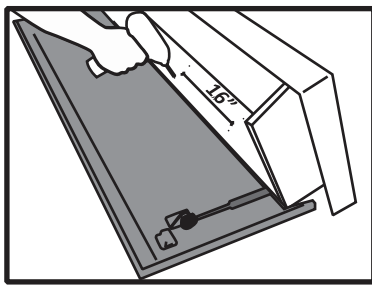

Figure 2

Depending on your placement, you should be able to locate and anchor into at least two studs. You may even be able to anchor into three studs. If you can only find two studs, use the supplied self-drilling wall anchors for supplemental support. ***Under NO circumstances should you attempt to use only wall anchors to support this shelf.*** The shelf **MUST** use **AT LEAST (2)** pine 2x4 studs and the shelf brackets to fully support the finished loaded weight. (More on that later)

Step 3.

With the help of a friend, using a level and your original measurements, hold the shelf in its desired location and transfer the pilot hole locations to the wall. See Figure 3.

You should be using a minimum of two studs for this step. Each stud should have (2) screw locations. Mark the internal screw holes, making sure to leave adequate space between them. Mark the hole locations for the wall anchors, if used. Make sure to hold your shelf nice and level for this step or your final installation will be crooked.

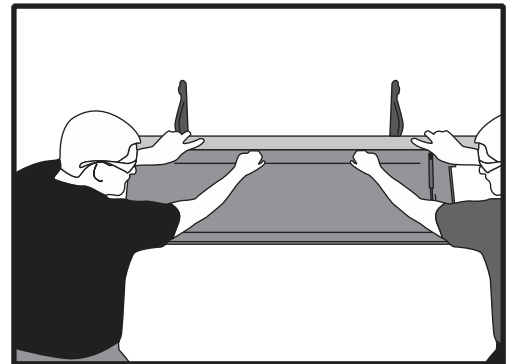

Figure 3

Step 4.

With the wall marked for level shelf installation, install the self-drilling wall anchors in their holes to support the two holes that do not fall on studs. See Figure 4.

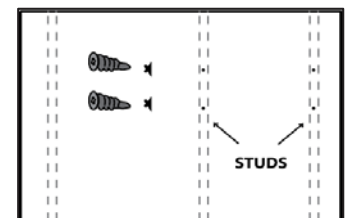

Figure 4

Step 5.

With the help of a friend, hold the shelf at its mounting location. Line up the holes in the shelf with the marks in the wall and the wall anchors. Install the first of six long wood screws into the wall. If you are using anchors, we recommend starting with an anchor hole first. See Figure 5.

With the first screw installed, have your friend hold the unit in place. Check for level. This will be your last chance to make sure the shelf is level. Make any necessary minor adjustments. Install the remaining 5 screws.

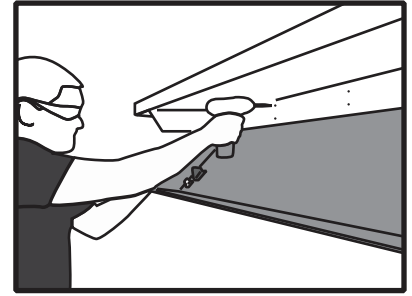

Figure 5

Step 6.

The shelf brackets MUST be installed on TOP of your shelf because this shelf opens from the bottom.

DO NOT ADD ANY WEIGHT until you have firmly mounted and anchored your brackets to the top of the shelf.

Have your friend help you support the weight of the shelf until you can get the brackets tightly mounted. Depending on the placement of your shelf, you may not be able to anchor both brackets into studs. We highly recommend that you use at least 1 stud. We have supplied (4) self-tapping wall anchors. Two are intended for use inside the shelf (only if necessary), while the other two are to be used with the wall bracket (only if necessary). Again, if you can, use two studs. **Do not add weight to your shelf either inside, or on top, until both brackets are fully installed.** Mark and install the brackets to the wall first. See Figure 6.



Figure 6

Insert screws into the TOP of the shelf with supplied 5/8" screws. See Figure 7.

Step 7.

The RFID Locking System

Install your batteries into the locks before closing this unit.



Figure 7

NEVER CLOSE AN RFID UNIT WITHOUT A BATTERY IN ITS LOCK. THIS WILL PERMANENTLY LOCK THE UNIT.

A couple notes about the RFID locks in the 1242 Rifle Length Shelf:

- **Your Tactical Walls RFID key cards come added to the locks and ready to rock**
- **It is NOT necessary to program the lock or to add the keys when received from the factory**

The 1242 Rifle Length Shelf has two RFID locks. They are connected by an antenna, so you only need to swipe over one of the locks to open your shelf. The “sweet spot” where you must swipe your card over the lock comes marked with a sticker for you to get used to where the key should be. The 1242 has two and you only need to hit one. Do not swipe too quickly. Putting your card on the lock works best. Once you swipe over either lock, immediately press up on the bottom of the shelf on both sides to release the tension. Move the key away from the lock when complete. Keeping the key over the lock will cause the lock to continue cycling, and this will wear the battery down.

If you are not adding additional keys to this unit, you may now move on to Step 8.

Otherwise, continue here to learn more about the RFID locking system that comes with your unit.

You may want to add other RFID key products to this lock. Tactical Walls offers key cards and key FOBs. There are many other products available for sale on the internet. If you choose to purchase other products, such as rings or wrist bands elsewhere, make sure you purchase keys that use 125kHz antennas. NOTE: The smaller the RFID key, the more precisely you will have to swipe the lock. This is one of the reasons we chose cards and FOBs only.

For video demo of adding keys to and deleting keys from a lock, go to <https://tacticalwalls.com/wp-content/uploads/RFID-key-program.mp4>

Adding User Cards or Fobs (Must be done on both locks of the 1242 Rifle Length Shelf)

- A1. Present the programming card (marked "Programming Card") to lock.
- A2. Lock will make a rapid ticking sound. Present a key card/fob to the lock within three seconds.
- A3. Two tones will indicate that the user card/fob has been accepted.
NOTE: Four rapid tones indicate that this key has just been deleted. Start again from A1.
- A4. Test that the lock can now be opened with this card/fob.

Deleting a User Card/Fob (Must be done on both locks of the 1242 Rifle Length Shelf)

- D1. Present the programming card to the lock.
- D2. Lock will make a rapid ticking sound. Present user card/fob to the lock within three seconds.
- D3. Four rapid tones indicate the card/fob has been successfully removed.
NOTE: If all key card/fobs have been lost all users will need to be deleted and re-enrolled.

Deleting All User Cards/Fobs

- DU1. Present programming card to lock.
- DU2. Lock will make a rapid ticking sound. Present and hold programming card to lock.
- DU3. Sixteen beeps will sound followed by one long tone indicating all user cards/fobs have been deleted.

If you need to change the program on the programming card, initialize the locks. In the case of the 1242, you will need to initialize both locks (you can use the same programming card), then program your keys to both using the newly initialized programming card. To do this, you will need to detach the lock from the shelf by taking out the 4 screws holding the lock in place. The Programming Button is behind the lock. See Figure 8.

Initializing the lock

- Z1. Press the programming button on the back of the lock. See Figure 8.
- Z2. Lock will make a rapid ticking sound. Present the programming card to lock within three seconds.
- Z3. Two short tones indicate the programming card has been initialized.
Multiple locks can be initialized using the same programming card.

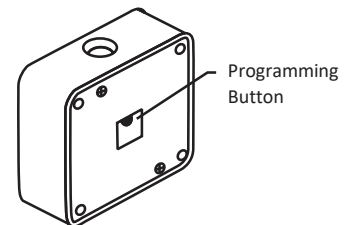

Figure 8

Features & Specifications of your TW-EL1 RFID Lock

- Simple to program without PC and software
- 50 users per lock capability
- Minimum 30,000 latch openings per life of battery (Lithium battery included)
- Low battery audible warning
- Fail unlocked when battery fails
- Audible signal upon card presentation

Specifications	
Dimensions	Lock: 7/8"D x 2-3/8"W x 2-3/8"L (21.8mm x 60.1mm x 60.1mm) Alarm Pin: 3/4"D x 1"W x 2-11/32"L (19mm x 25.4mm x 59.7mm)
Cycle Rating (Battery Life)	30,000
Holding Force (Manufacturer Tested)	Alarm Pin - 450lb (240kg)
Operating Temperature	14°F to 140°F (-10°C to 60°C)
Power Requirements	3V - Lithium Battery
Low Battery Warning	Audible Alarm will sound for 10 seconds. Fail Unlocked when battery power fails.
Warranty	3 Year Limited Warranty (excluding battery)

Step 8.

Accessory Placement

Lay your foam insert onto a level surface with the beveled edge facing you, sticker side down. The beveled edge will fit against the sloped front interior wall of the shelf floor. Begin placing your items as you would like to have them situated inside your shelf. Please keep in mind the weight and size of your items. You will only have 3 ½ " of interior height inside the shelf. Weight is also a factor. We recommend no more than 20 pounds of gear inside the 1242 RFID RLS.

The foam is adhesive backed. The more foam and adhesive backing you remove the less bonding action is taking place. Do not plan too many cavities or place them too close together. Try to leave at LEAST an inch of foam between components- two inches would be even better.

Trace your items, allowing for a snug fit. See Figure 9. Make nice clean lines in your tracing. Sloppy tracing makes for sloppy cutting and sloppy fit.

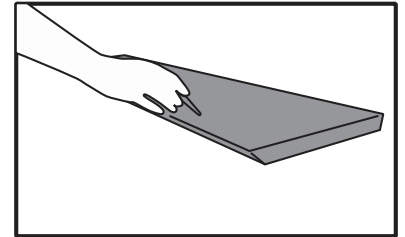

Figure 9

Step 9.

Cutting your foam

For a video demo of this process, go to <https://www.facebook.com/TacticalWalls/videos/1745286672155987/>

Use a brand new sharp blade (such as a razor) for this process. Be very careful with this razor. Do not cut yourself. Do not cut your work surface, your furniture, or your floor. Do not carry out this step on your table, furniture, or floor without placing a protective surface underneath the foam that will be able to take the cuts of your razor. If you use cardboard to protect your surface, we recommend several layers of cardboard. Tactical Walls is not responsible for any damage you may inflict on your home, your property, or yourself.



Figure 10

Begin cutting along your trace lines. See Figure 10. If you cut the cavity too small on this step you can always remove a little foam later to make it bigger, however, you can't put the foam back in. NOTE: We sell replacement foam on our website.

Your gear will dictate how deep to cut your foam. For instance, you should not need to cut the whole way through for a hand gun, whereas you may want to for a rifle. We recommend trying to have your items buried at least 3/4 of the way into the foam. Also, by not cutting all the way through, you will retain the foam's integrity and adhesive properties. Test fit as you go so you know if you need to make the pockets deeper or wider. Make sure your firearm is unloaded and the chamber is empty while checking fit. In addition, we recommend that you store **ALL** firearms with an empty chamber.

Step 10.

Practice installing your foam into the shelf before removing the adhesive backing paper. The adhesive backing is quite sticky and once you peel the backing paper, you want to be able to place it smoothly, in one fluid motion. Once you are confident in your placement, peel the backing and install the foam with the angled edge in the proper orientation. See Figure 11.



Figure 11

Final Thoughts and Considerations:

The shelf's primary function is to allow quick access to your tools to defend your home. Keep the keys handy and practice opening your shelf in various light conditions to become proficient at it.

When installing or removing any firearm avoid placing your finger anywhere near the trigger and trigger guard, and **NEVER** store your firearms with a round in the chamber.

The shelf is an actual shelf, but please **DO NOT** overload it; neither inside, nor on the top. It was not designed to hold a set of encyclopedias. A few basic trinkets and decorations should do just fine., which is just enough to pass as a normal decorative shelf.

We **DO NOT** recommend you exceed a maximum loaded weight of 40 lb for the 1242 RFID RLS, with no more than 20 lbs inside and 20 lbs on top of the 1242 RFID RLS.

We appreciate seeing customer installs!

Take a picture and send it to show_us@tacticalwalls.com for our website and social media.

If you have any questions or comments, reach us through our website chat feature or by emailing us at support@tacticalwalls.com

Thank you for your purchase and enjoy your Tactical Walls product!

RETURN POLICY

At Tactical Walls, our goal is to ensure your complete satisfaction with your purchase. If you are dissatisfied with your purchase, you may return it within seven business days of receipt of merchandise.

Please read all conditions below. If conditions are not met, Tactical Walls reserves the right to refuse the return or to charge a restocking fee.

The Return Process

1. Obtain an RMA (Return Merchandise Authorization) number from our support department.
2. Write your RMA number clearly on the invoice that was shipped with your items.
3. Place the invoice and the product back into the original carton.

Do not use any carton other than the original as improper packing of mirrors could result in damage to the items being returned and a deduction from your refund amount.

4. We recommend you ship via insured ground service with a tracking number. Return shipping charges are the responsibility of the customer. We are not responsible for lost or damaged packages.

5. Send pre-authorized returns to:

Tactical Walls Return Dept.

611 Williams Ave

Shenandoah, VA 22849

Conditions

- All returned items must be in new condition, in their original box, and must include all packing material, instructions, invoice, and all accessories.
- Tactical Walls is not responsible for personal items left in returned merchandise.
- Defective items may be exchanged at our discretion for the same model or equivalent model.
- RMA numbers are valid for 10 days. Any items received outside of the RMA time line will only be refunded at half of their original purchase price.
- Tactical Walls is not responsible for any consequential or incidental damage resulting from the sale or use of any merchandise bought from us.
- Shipping charges will not be refunded.

Refunds on returned items will be issued via Credit Card or Check once we receive the product. Shipping costs are not refundable. It may take up to 7 business days for the refund to appear on your statement.